

The Moving Church News

A Church and Community Magazine



St. Mark's Church Biggin Hill February- March 2023

Hennis Upholstery



Re-Upholstery • Bespoke Sofas & Chairs
Tailored Loose Covers • Curtains & Blinds
Headboards & Window Seats

Accounts with
Sanderson, Zofany, Romo & many more

(RE-)COVERING LONDON & THE HOME COUNTIES

T: 01689 800099

E: hennisupholstery@gmail.com

W: www.hennisupholstery.com

30 YEARS ESTABLISHED – FAMILY BUSINESS

Welcome to the Moving Church News the bi-monthly magazine of St. Mark's Church, Biggin Hill

Contents

Services At St. Mark's	4
Explaining A Pantomime To An American	5
Christmas Visitors to St. Mark's	8
At St. Mark's...	10
Fairtrade at St. Mark's	11
Biggin Hill Art Group	11
Winter Colour In The Garden - Beating The Blues	12
Friends Of The Park	14
'A Light In The Darkness'	16
It's So Easy...	18
Church Registers	19
Church Flowers	19
Christmas Messy Church	21
Councillors' News	22
Forest Church	23
Norheads Surgery Patient Participation Group	24
Baptism at St. Mark's	26
Community Phone Numbers	30
The Next Moving Church News	31
Keeping Up with Everything At St. Mark's	31
Advertising in the Moving Church News	31

Front cover - Please see page 21

St. Mark's Parish Church, Biggin Hill

Church Road, Biggin Hill, Kent, TN16 3LB

Parish office: 01959 577816

Email: admin@movingchurch.org

St Mark's website: www.movingchurch.org

Vicar	Revd. Alison Newman	01959 540482
Church Wardens	Patrick O Sullivan	01959 572684
	Rohan Perera	01959 574355
Reader/Evangelist	Mark Newman	01959 540482

**For Hall Bookings, Baptism, Wedding and general enquiries,
please contact the Parish Office.**

**Office hours: Monday, Tuesday, Wednesday
9.30 am to 12 noon**

Services at St. Mark's

First Sunday in the month

**8.00am Communion -
Book of Common Prayer**

10.30am All Age Worship

Other Sundays

10.30am Parish Communion

Wednesdays

10.00am Holy Communion Service

Ash Wednesday Service 22nd February 10.00am

Explaining a pantomime to an American..

Part of our family tradition is usually to go and see a pantomime at Christmas (oh yes we do!) This year's production at the Churchill theatre, *Jack and the Beanstalk*, was excellent. Have you ever tried explaining the concept of pantomime to an American? They don't have these shows in the States.

Here is the essence: the principal boy is played by a girl, but that doesn't mean the principal girl is played by a man; the dame is also played by a man, usually in outrageous clothing. Often two people dress up as an animal. Then there are certain stock phrases – 'he's behind you', 'oh yes you will'/'oh no you won't'. On top of this the audience is expected to participate. This is enough to confuse someone from outside the UK!

The wonderful thing about pantomime is that there is always a clear distinction between good and evil. Cheers for the 'good fairy' and boos and hisses for the evil character. In the end good always wins, and evil is overcome. Usually, a couple in the story find true love and they all live happily ever after.

Sadly, we don't always see this in real life. As we look back over last year, we see so much evil stalking the world: war, terrorism, atrocities, I could go on. One of people's favourite New Year's resolutions is to see peace in our world. Who wouldn't long to see that? It's something we pray for regularly in church.

Christmas gives us the wonderful and true story of a baby born to Mary in a stable. I'm sure many of us enjoyed watching nativity plays last month in December. Yet Jesus was born into the real world of Roman occupation, of King Herod the dictator who was notoriously cruel, ordering the massacre of children under 2 in Bethlehem. The parents of Jesus fled as refugees to Egypt when he was very young. Mary and Joseph knew what it was to be fearful as they protected their precious son.

In the church's year we have entered the season of Epiphany when we think about the light of Christ who came into our world. By various signs Jesus made himself known as the Son of God. Of course, light can shine into the darkest of places and can

reveal all sorts of dirt and mess. In the same way Jesus came to show us how we need to put our lives right with God. He came to show us what's wrong in our own lives, how we have all messed up.

Many people leave Jesus in the manger as a perpetual Peter Pan. But we all have to make a personal response to Jesus. The Wise Men came and worshipped Jesus, bringing Him gifts of gold, frankincense and myrrh. They recognised Him as the Son of God. Do you also recognise Him for who He is, or have you put Him away with the Christmas decorations?

Revd Alison Newman



Worried? Problems?

We at St. Mark's would like to help you. If you would like our help, or simply want someone to talk to, please call

01959 540482 (Vicar),

The Chartwell Charities



Professional and sympathetic house clearance services to make a stressful task hassle free

HOUSE CLEARANCE SPECIALISTS

Our Services

HOUSE CLEARANCE

We gratefully accept small to large furniture, electrical appliances, clothing, shoes, accessories, jewellery, CDs, DVDs, books and homewares for resale in our charity shops, including items we can professionally recycle, FREE of charge even if in poor condition.

WASTE DISPOSAL SERVICE

We safely dispose of any items that cannot be recycled for a competitive fee.

How it works

- ✓ We will visit your property at a time convenient to you to discuss the removal.
- ✓ Our professional team will carry out the house clearance as quickly and as safely possible.

Declutter and clear your home, garage, loft or office and help us change lives today!

The Chartwell Cancer Trust raises funds to make improvements to cancer care for patients, families and medical staff across South London, North Kent and East Surrey aiming to change lives of both adults and children suffering from cancer and leukaemia.

📞 01959 570322 ✉ collections@chartwellcancertrust.co.uk
BOOK ONLINE: chartwellcancertrust.co.uk/house-clearance/

The Chartwell Cancer Trust, Aileen McHugo Building, Westmore Green, Tatsfield, TN16 2AG
 E: info@chartwellcancertrust.co.uk W: chartwellcancertrust.co.uk Charity No. 1109784

Christmas Visitors to St Mark's



Fairchildes School

40 singers from Fairchildes School brought a series of cheerful songs to the St Mark's Christmas Fair in late November. Congratulations to all the children, not least the memorable soloists.

Then the whole of Year 1 came for their own Christingle service in mid-December. Again, there was some great singing.

Charles Darwin School

Students from Charles Darwin School gave a brilliant concert to their parents on Wednesday 30 November, with instrumentalists, several vocal groups including some of the cast of Elf the Musical, and the Year 7 choir. Well done to Miss Mace for her amazing work as Head of Music!



Beckenham Concert Band

The next group to come and perform was Beckenham Concert Band. Conductor Felicity Cliffe brought a lively interpretation to some popular classics, including a selection from Cats, the Ukrainian Bell Carol, and two carols. A special word must go to David Chapman, who sang a brilliant solo of *O Holy Night*.

The concert was held in aid of St Christopher's Hospice. Anne Nash, Consultant Nurse at St Christopher's, explained that the Hospice has 30 inpatient beds. On the week of the concert,

they were supporting 1297 patients in the community. They cover 5 London boroughs: Bromley, Croydon, Lambeth, Lewisham and Southwark. The Hospice only receives one third of its funding from the NHS and needs to fund raise £18 million each year to support its end of life and Bereavement services. The concert raised over £700



Christmas week

We began with our traditional Service of 9 Lessons and Carols, at which several members of the community read the birth narrative. On the Wednesday we held a Blue Christmas, with a reflective element. On the Thursday there was a Christmas Miscellany, an alternative carol service, with lesser-known carols and some well-rehearsed drama! On the Friday about 25 children attended Messy Church, while on Christmas Eve we had two very full Christingle services. Again, visitors attended the first Communion of Christmas at Midnight and yet others on Christmas Day itself. It was wonderful to welcome so many local people back after two years of uncertainty.

The message and significance of the birth of Christ is clearly of importance to many!

Mark Newman



At St. Mark's.....

Music At St. Mark's

St. Mark's singers and Music Group. Songs and fellowship with a lively touch. Call Chris on 01959 700815 for more details

Baby & Toddler Group

Every Monday and Friday from 10.00 am in the Church Hall during school terms. Contact the Parish Office for details -01959 577816 - or just come along.

Home Groups

Home groups meet every fortnight for fellowship and Bible Study. For more information contact Alison on 01959 540482

Bell Ringing

Please contact the Parish Office on 01959 577816

1st Biggin Hill Guides

Please contact Rosemary Spurway on 01959 575717

ALLENBY

COACH HIRE

DAY TRIPS BIGGIN HILL

Pick up opposite Waitrose, Main Road

2023 TRIPS

Please note our driver will only return to the same drop off points as pick ups

- Wed 8th February – Orchids at Kew Gardens £36pp
- Thurs 10th February – Greenwich Market & Maritime Museum £22pp
- Fri 24th February – Snowdrops at Ighiteam Mote £31.50pp – NT members free entry £22pp
- Tues 28th February – Brighton Pavilion £39pp/Brighton Day trip £22pp
- Wed 8th March – Day in Whitstable £22pp
- Mon 13th March – Port Lympne, Lympne £40pp
- Tues 21st March – Greyhound Racing – Brighton £22pp
- Thurs 30 March – Claremont Gardens/Garsons Garden Centre £33 – NT members free entry £22pp
- Tues 4 April – Portsmouth/Gun Wharf £22pp
- Wed 12 April – Rummey, Hythe & Dymchurch Railway £45pp
- Mon 17 April – Crossness Victorian Pumping Station £42pp
- Thurs 20 April – Arundel Tulip Festival £45pp
- Fri 28 April – Day in Deal £22pp
- Wed 3 May – Bluebell Railway £18c
- Thurs 11 May – Marble Hill House £22pp
- Fri 19 May – Day in Eastbourne £22pp
- Wed 24 May – Bekenscot Model Village & Gardens £31pp
- Tues 30th May – Day trip to Southend on Sea £22pp

Tel : 01883 330095 or Email enquiries@allenbycoachhire.co.uk
WWW.Allenbycoachhire.co.uk

Fairtrade at St. Mark's



It was agreed at a PCC meeting some years ago that coffee, tea and sugar provided at St. Mark's should carry the Fairtrade label whenever possible. Neil & Chris Walker supply the church kitchen with these items. Please let them know if you see stocks running low. If for any reason you need to purchase these items for St. Mark's yourself please try to buy those with the Fairtrade logo.

FAIRTRADE is a different way of doing business and is a growing international movement for change. Fairtrade is about better prices, decent working conditions, local sustainability, and fair terms of trade for farmers and workers in the developing world. By requiring companies to pay sustainable prices (which must never fall lower than the market price), Fairtrade addresses the injustices of conventional trade, which traditionally discriminates against the poorest, weakest producers. It enables them to improve their position and have more control over their lives.

With Fairtrade you have the power to change the world every day. With simple shopping choices you can get farmers in the developing world a better deal. And that means they can make their own decisions, control their future and lead the dignified life everyone deserves. There are many other products that are Fairtrade - please look out for them whenever you are shopping. They are often more expensive than similar products, but this reflects the fair price paid to the producers.

If you enjoy drawing or painting -
 The Art Group meets in St. Mark's Church Hall on Wednesdays from 2pm.

Organised by Biggin Hill Community Care Association

For contact details please see page 27.

Supporting people over 50

Friendly

Art

Group

Winter Colour in the Garden - Beating The Blues

Many plants spend their winter dormancy building up reserves for the following summer, while others perform during the winter months, proving irresistible to us and our nature friends. Many of which are rated much higher than our well-known spring and summer counterparts, due to the time of



year. *Cornus sanguinea* 'Midwinter Fire' is one of many of the *Cornus* spp or dogwoods. Showing off their brightly coloured stem colours in the winter sun, the reds, lime greens to yellow and flame cheer up any dull corner. To ensure they achieve their goal, a third of the plant needs to be pruned each spring, with each stem down to two or three buds, encouraging new shoots, of which these will provide the rich colours the following winter.

Other plants take centre stage this time of year, as flowers bloom not only to provide colour but intoxicate the air with scent. The odd brave bee during mild spells investigates each individual flower in search for nectar. During extreme cold temperatures, some flowers do suffer and may become damaged, but there are plenty more buds waiting to open.



Viburnum farrei and *V. bodnantense* 'Dawn'. The former, a shell pink and slender shrub, the latter, a vigorous tall shrub with dark pink flowers, adorn the garden with its exotic fragrance, so too does the Mahonias as their yellow racemes rise above the foliage, particularly *M. bealei*, flowering after Christmas.



Well-known for its fragrance is the witchhazel, *Hamamelis* spp, their unusual spidery blossom exudes its intoxicating scent (almost too powerful at times). They are slow growing but will grow quite large eventually. Flowers range from yellow, orange to red during January and February. Will grow in most soils

but better in acidic soil.

The Queen of all winter fragrant shrubs is *Daphne bholua* 'Jacqueline Postill'. A slow grower but makes up for their exotic richly scented blooms among emerald, green leaves. It will eventually reach 150 to 200cms in 10 years, but certainly brings a cheer to a cold frosty morning.

The ground can be quite bare in winter, but there are several evergreen perennials that will not only cover but flower right through to spring. The Hellebore with its dark evergreen foliage opens to allow the flower stem to break through and provide snow white, pinks and red, even yellow and green colours to the winter palate.



In the larger garden, small trees can make a dramatic effect in the garden, as seen in many gardens during this time of year. These trees provide drama, structure, height, colour and interest. Many

can be purchase as multi stemmed rather than the one stem normally associated with trees.



Acer griseum, the paperbark maple, as described, the peeling mahogany coloured bark and its papery like appearance always attracts interest, but stands out beautifully during the winter.



Betula x utilis var. Jacquemontii 'Doorenbos' and B. x u. jac. 'Grayswood Ghost' as the name suggest provides a pure white stem, especially against the backdrop of an evergreen. Even better with lamps at the base of the tree, spectacularly illuminates at night, totally transforming the garden dramatically.

Enjoy the garden this winter!

Dates for your diary:

Wednesday 15th March 2023, we have a talk by Kevin Tooher on A 'Walk with Daffodils' and Wednesday 19th April 2023 we have a talk by Head Gardener, Rory Burgh, 'The Wonders of Titsey Place'. From 8 to 10 pm (doors open at 7.30). Entrance for members is free, non-members £3.

1st April 2023, Spring Flower Show, doors open at 3pm and prize giving at 4.15pm, entrance free. Refreshments, trade table and raffle available at all our events.

The Biggin Hill & District Horticultural hold many events throughout the year. Should you wish further information, please contact Nick Hagon Chairman (Biggin Hill & District Horticultural Society) 01959 575799 between 6.30 and 9pm.



We need more volunteers on Saturdays and mid-weekdays to help maintain the Sensory Garden, Kings Road, Mine Copse and open spaces in Biggin Hill.

Join Biggin Hill Friends of the Parks and help us to maintain The Sensory Garden in The Rec, look after

woodlands or keep Kings Road Open Space attractive and safe for adults and children to use and enjoy! Contact Nick Hagon on 01959 575799 for further information or wish to join as a volunteer, between 6.30 and 9 pm most evenings.

BRIGHTLIGHT Electrician

Private & Commercial

**NAPIT Part P registered
J.I.B. qualified
Over 30 years experience**

**Rewires
Additional points
Lighting
EV chargers
EICR test
Fuseboard upgrades**

**Call Terry on 07930 673210
brightlight01@btinternet.com**



**New dog groomer
to your area!**

- Based in Badgers Mount
- City & Guilds Qualified
- Fully Insured
- 1 to 1 service

Contact Katie 07956 436670

Dapper Dogs Parlour

BLINDS • SHUTTERS • CONSERVATORY BLINDS

Verticals | Rollers | Venetians | Romans | Panels
Pleated | Conservatory Blinds | Plantation Shutters



- FREE Professional design advice on all of our products
- Appointments in the comfort of your own home - at times that suit YOU
- A fantastic range of styles, colours and products from top named brands to choose from
- Reliable and friendly customer service
- Expert Measuring and Fitting
- Only using manufacturers who are compliant to BS EN13120

From your Local Specialist Blind supplier based in Biggin Hill

To discuss your requirements call us on: **01959 509179**
email: info@benasa.net or visit us online at www.benasa.net



'A LIGHT IN THE DARKNESS'

Richard Gilbert Scott's first independent architectural commission was St Mark's Church, Biggin Hill, consecrated in 1959, where the roof and building materials from a disused Victorian church in Peckham were reused in conjunction with a campanile plan form in his grandfather's (Sir George Gilbert Scott) abstracted Gothic style.

The atmosphere inside any church is not only enhanced by the quality of the architecture but by the quality of the lighting and sound system within. It is a joy to occupy a building that is not only a focal point for our Village, but a significant and important building designed by a celebrated architectural practice, George Gilbert Scott Architects. The building was also created by a visionary, Rev. Vivian Symons and was funded through individual and community contributions, sometimes brick-by-brick donations.

We are privileged to be the custodians of this beautiful building to worship here and to serve our community. We are now asking for help from this community again.



Our lighting system has served its purpose for many years but is no longer providing the lighting levels or functionality that are needed for the building as we seek to respond to the changing demands and uses, both for our services and for a wider community use. It is now in need of replacement; it is old lighting technology and it is becoming



increasingly difficult to find replacement fittings and bulbs.

We have been working in consultation with CES Lighting & Electrical Services to design a new system that will cater for our needs now and into the future as we look to make our church building more accessible to the needs of the church and our wider community here in Biggin Hill. The proposal will include a new control system, allowing

individual light switching to provide a high variety of lighting configurations ranging from a general blanket light spread to specific highlighted areas for a wider variety of events.

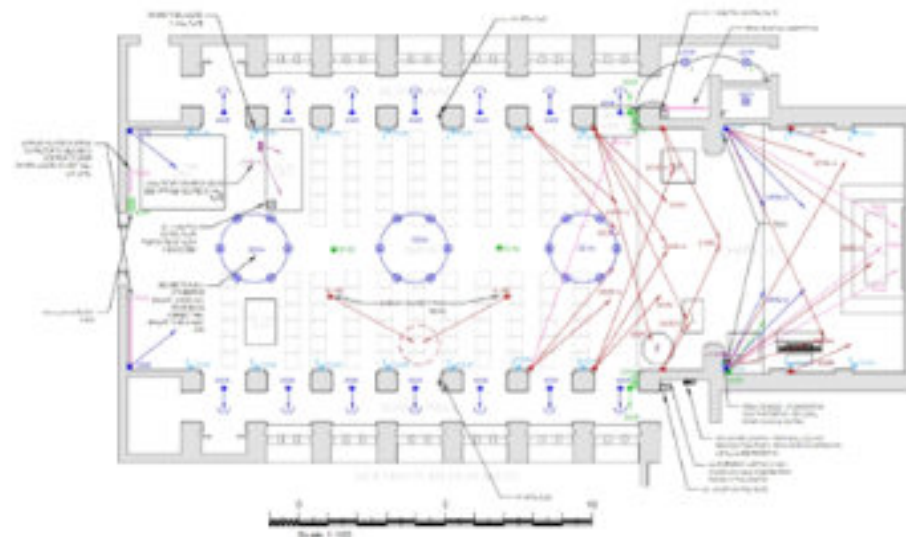

We have been fundraising for some time and now have more than £20K towards the cost of the works. We are setting up an appeal to the community for further donations. We need to raise another £20K in addition to grant applications currently in hand. Please would you consider making a donation to help us achieve this goal? This will enable us not only to continue our worship and serving the community, but to expand the use of the building for a variety of activities and events too.

If you are able to respond to this appeal, there are a variety of ways you can make payments in the following ways:

1. Send a cheque to the Admin Office, St Marks Church, 10 Church Road, Biggin Hill, Kent TB16 3LB -payable to St Mark's PCC - marked 'lighting fund 2023' or make a donation online – bank details on request.
2. Scan the QR Code with your phone and then select 'web' to follow the payment guide.
3. On your computer, type the following <https://www.movingchurch.org/support> and follow the website 'support' guidance.

Please reference your donation with 'LightFund 2023'

Many thanks for your help.

If you have any questions please email us through the parish office at

admin@movingchurch.org



By Andrew Scott

It's so easy...

...to support St Mark's Church
and you can gift aid your donation too



Please go to our website by scanning the QR code
above with your phone and then select 'web'
OR
type <https://www.stmarchurch.org/support/>
into the app you use to search the web.

Then follow instructions on screen.
You will need your debit or credit card handy.

THANK YOU!

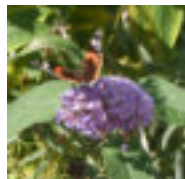

Orchard Garden Maintenance

Making your garden a delight!

- mowing
- digging
- pruning
- weeding
- planting
- hedge trimming
- pressure washing

Phone: 01959 570244

Email: orchardgardening.tn16@gmail.com

Your local
friendly pest
company

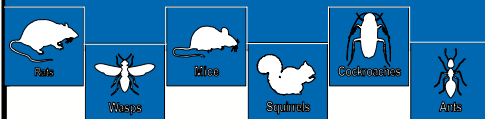

Contact us for expert advice

01959 565 777

info@safeguardpestcontrol.co.uk



24hr
Emergency
Plumbing
& Heating
Service



Registered installer of Aquilisa Showers
All types of WATER TREATMENT
and DRAIN WORK
All types of PLUMBING & HEATING
SERVICING of GAS BOILERS
Saving heating costs



**DAVID RUDD
& SON**

MIP RP

Registered Plumber

Tel: 01959 577072
Mobile: 07831 641664
GAS SAFE REGISTERED
Established 32 years

Church Registers

BAPTISMS

"We welcome you in the name of the Lord"

Millie-Jayne Wordley

FUNERALS

*"The steadfast love of the Lord never ceases, His
compassion never fails; every morning they are renewed"*

Sally Anne Phillips

Keith William Miles

Robert 'Bob' Thomas Wilkinson

Stella Marguerite Nelson

Albert George Hall

Alan James Wade

Roman Dougie Giles

BURIAL OF ASHES

Sheila Diana Saunders

Robert Easton

Flowers for Church



If you would like to make a
donation towards the cost of
flowers in church for a
particular week, to mark an
anniversary or a special event,
please contact either Caroline
Budimir on 01959 576093 or the
Parish Office on 01959 577816

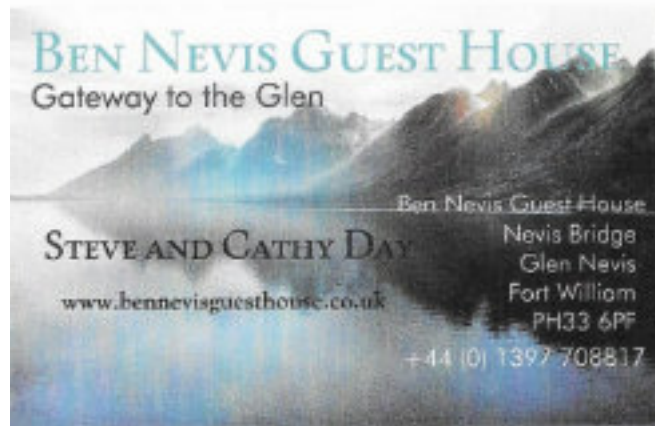

For all your floral requirements

FLORIST
A personal service at a competitive price!

Lily of the Valley

309, Main Road (opposite St. Winifred's Road)
Biggin Hill TN16 3JJ
01959 571445

www.lily-of-the-valley.co.uk

Mobile Chiropodist



Chiropody undertaken in the comfort of your own home

Mandy Gifford M.Inst.Ch.P
HCPC Registered

Registered Member of the Institute of Chiropody and Podiatry

Tel: 07944 763045



SEWING SERVICE

40 years' experience

Wedding Dress Alterations Specialist

Ladies & Gents Garments
Alterations, Restyling & Repairs

Biggin Hill
01959 546 551

Christmas Messy Church 23rd December 2022



Mark Sanger giving a talk about the Advent candles



Sophie Dunbar and Harrison enjoying one of the activities.



St. Mark's singers and musicians at the service of 9 Lessons and Carols on the 18th December

Melanie and Sophie your Independent Councillor Team.

Following on from the last edition, we wanted to focus on our role, and how we can work more effectively within the community.

But what does **COMMUNITY** stand for? We believe it's a **C**ommon **O**bjectives, **M**utual **M**issions, **U**nitng **N**etworks **I**ndividuals **T**ogether!

Our role, or job if you like, is to develop an understanding of the local community, its issues, needs, concerns and by being a main point of contact, lead and campaign effectively to deliver outcomes that make a difference.

We work closely with all organisations, agencies, associations, group and council, but in order to be fully effective we need to work as a whole team, with you as individuals as well!

What does **TEAM** stand for? We believe it's by working **T**ogether **E**veryone **A**chieves **M**ore!

In order to be fully effective we need your support and would ask that you consider using support tools already in place but greatly underused!

We often get reports of anti-social behaviour, theft, and burglary through social media and gossip groups. But this is not reporting crime! It is not getting the true picture of what is happening in our community and on the transparent score boards. Without proper and active crime reporting the Police are blissfully unaware of the reality of living within Biggin Hill.

Although we do work closely with our Safer Neighbourhood Policing Team and can pass on anecdotal information, we cannot report incidents of crime for you. Nor can we make you feel totally safe and secure within Biggin Hill.

But what about joining a Safer Neighbourhood Watch. A watch is about bringing together the community, in bit size chunks, streets, lanes, hills or closes, for the purpose of crime prevention and making safer places to live, work and play. It's about looking out for each other, sharing of information, reporting and making others aware of suspicious "going ons". It is not curtain twitching, nosey parkers, or interfering neighbours!

It is a do-it-yourself thing, run as you so see fit, doing as little or as much as the group wants, with one person as being the lynch pin! The

police do not run the group but have the ability to support the group and it's a chance for us, the local residents, to hold the local policing team to account for the work they do in and around the ward. It is also an opportunity to set them priorities and get them to focus on issues that are affecting our community.

The population of Biggin Hill is nearly 10,000 residents of which 0.25% are actively working as a watch to look out for themselves and their neighbours!

Come on Biggin Hill Community!

It's easy, non intrusive and you can take from it as much or little as you want. It's about being alert, sharing information and taking time to be neighbourly! You do not take on responsibilities of the police, you are not vigilantes and certainly you are not ever put at risk!

If you are interested in keeping not only yourself and family safe, but wanting to build a safer neighbourhood and share information on keeping safe, then please do contact us and we will assist in getting you started.



Melanie Stevens – 07900 171266
melanie.stevens@bromley.gov.uk



Sophie Dunbar – 07929 365228
sophie.dunbar@bromley.gov.uk



FOREST CHURCH

Sunday 12th February
3.30pm

We shall be enjoying activities
in the Church grounds so bring
outdoor clothing!

For Adults & Children.
Followed by cakes
and drinks



Patient Participation Group Norheads Surgery

Newsletter January 2023

Welcome to this special New Year's edition of the Norheads Lane Surgery's PPG newsletter. We present here a brief overview of the PPG and its aims.

What is the PPG?

The purpose of the Patient Participation Group, PPG, is to provide a forum for the involvement of patients with the work of the Norheads Lane surgery. Its membership potentially covers all patients as well as the doctors and surgery staff. In 2016 it became a contractual requirement for all GP surgeries in England to establish a PPG. All the country's PPGs have similar objectives, but they may differ a little in the details of their organisation and services.

The PPG is managed by an executive committee comprising the surgery's two doctors and the Practice manager, and several patients. The PPG Executive committee is headed by a chairman supported by a secretary and treasurer. It meets frequently throughout the year and holds an AGM usually in the June or July. We are keen for as wide a range of patients as possible to join the Executive Committee and support our activities.

What does the PPG do? The PPG Executive Committee members provide:

- information about events at the surgery – e.g., flu vaccination clinics – delivered by emailed newsletters, surgery entrance notice board, or word of mouth;
- support to the practice nurse by supervising the queues for vaccination clinics;
- raise funds for providing equipment for the surgery – e.g., clinical couch
- representation at the Five Elms PCN meetings.

We are always trying to widen our reach out to patients by adding to our email list. We are also keen to broaden the range of patients on the Executive Committee: if you would like to participate, please contact the PPG Chairman, David Dilling at daviddilling49@gmail.com.

LOCAL COMMUNITY CARE SERVICES

Useful Information on the local community care services available (No GP referral required) - BIGGIN HILL COMMUNITY CARE ASSOCIATION: Tel: 01959 577400; email: bigginhillcommunitycare@gmail.com; website: www.bigginhillcommunitycare.org

FUND RAISING BY THE PPG

One of the activities of the PPG Executive is that of raising funds to support the work of the Norheads lane GP practice. A recent example of successful fund raising was the purchase of a medical examination couch for Dr Bolanle Idowu's consultation room. Our current fund-raising scheme is the 50:50 club. The 50:50 Club. This fund-raising scheme is based on 50:50 club members paying £12 for a numbered ticket covering a year's worth of monthly draws. The draws will be made on the 3rd Wednesday each month at the Norheads Lane surgery premises. Eligible ticket numbers will be added to a random number generator and the drawn ticket will be awarded a monetary prize to the value of 50% of the total monies for that month. 50:50 club members must be a patient at Norheads Lane surgery or complete their application for club membership at the surgery premises. Members may buy any number of annual tickets. The Club's recent draw (December) awarded ticket holder the prize of £32.50, with the same amount going to the PPG account. In this way, both the surgery and the club members benefit from each draw. As new members join, so the prize increases. We will be contacting Club members soon to arrange for 23/24 annual subscriptions and we would like to encourage Standing Orders to be set up, where possible, please. Thank you to all our 50:50 Club members, who have made significant contributions to the costs of the clinical beds recently purchased by the surgery. If you would like to join the 50:50 club, please ask at the surgery or contact Lynne Martin at funkystork2@hotmail.co.uk

FIVE ELMS PRIMARY CARE NETWORK (PCN)

What is the PCN? Primary Care Networks (PCN) have been established across the country since 2019 as part of the NHS Long Term Plan for Primary and Community Care. Each of these PCNs incorporates several local GP practices. The aim is for the PCN to provide a number of additional services and support for patients and the GP practices. As explained below, the idea is that greater benefits are achieved by providing the PCN's additional resources centrally rather than spreading them thinly across each surgery. The PCN aims to join-up the work of

General Practices, Community Services, Mental Health Services, Social Care, and various Voluntary Organisations – creating “holistic care”.

There are five PCNs covering the Borough of Bromley. Our Norheads Lane GP practice falls within the Five Elms PCN, along with GP practices at Stock Hill, Southborough Lane, Bromley Common, and Summercroft. These five GP practices provide care for a total of just over 45,000 patients. The Clinical Director for Five Elms PCN is Dr Taraq Waheed, who is based at Southborough Lane GP practice. [web address: www.FiveElmsPCN.com]

More information about the Norheads Surgery PPG and the Five Elms Network Primary Care Network (PCN) Group can be found on the surgery website - norheadslanesurgery.co.uk



Baptism at St. Mark's

Millie-Jane Wordley was baptised at St. Mark's on the 13th November 2022

The photographs show Millie and her older sister Dolly-Rae with their mum Kelly.



Supporting people over 50



Registered Charity No: 1056336

Wednesday Lunch Club

The Friendly Club!

Enjoy a warm welcome at our **Lunch Club** which is open from 12.15pm until 2pm. A three course meal is provided which is cooked on the premises. Afterwards hot drinks are served. It may be possible to provide transport within Biggin Hill at a small cost.

Biggin Hill Day Centre

Our **Day Centre** provides a friendly and sociable environment where you will be supported by our professional care staff.

Start the day with a cuppa and a chat!

Morning and afternoon activities. Three course lunch cooked on the premises. Transport option for Biggin Hill residents. The Centre is open on Tuesdays and Thursdays. Provides respite for carers

Do you have difficulty doing your grocery shopping?

Assisted Shopping

Our **Assisted Shopping** takes place on Friday mornings and is for Biggin Hill residents who live independently but need help with their weekly grocery shop. Please call Annette for more details - 01959 700411

All places must be booked in advance. For more information, please call us on 01959 577400 or email bigginhillcommunitycare@gmail.com.

You can also visit our website: bigginhillcommunitycare.org or scan the QR code.

We hire St. Mark's Hall, Church Road for our Day Centre and Lunch Club



Keeping IT Simple

*Solving all your technical support worries, calmly and patiently
in your own home, by someone who cares*

- > New Device Setup
- > Instruction & Tuition
- > Cleaning & Cooling
- > Virus & Malware Removal
- > Hardware Upgrades
- > Remote Support
- > Small Business Support
- > WiFi Routers & Networking
- > Cloud Storage
- > Data Backup
- > Data Recovery
- > E-mail Support
- > PCs & Laptops
- > Printers
- > Smartphones
- > Tablets
- > Televisions
- > Wireless Security Cameras

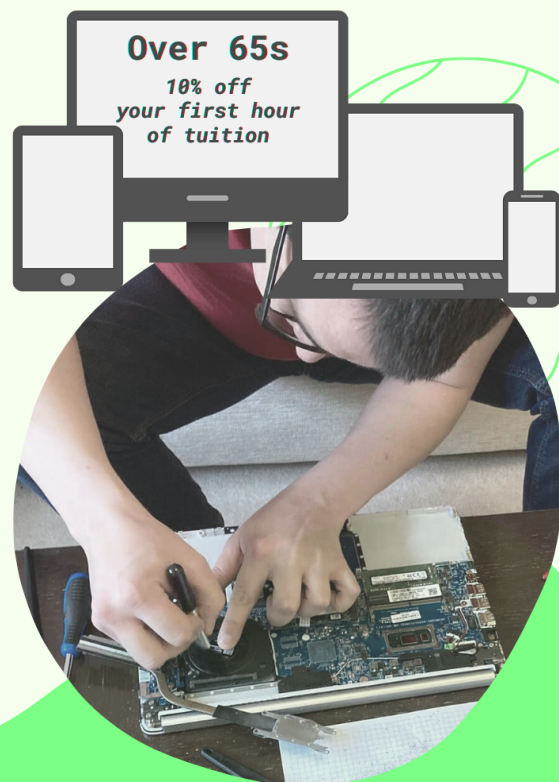

07375 416 176

dan@kisIT.co.uk



THE MOVING CHURCH NEWS

IS THE PARISH MAGAZINE OF

St. MARK'S CHURCH, BIGGIN HILL

St. Mark's is known as the "Moving Church" as in the 1950's it was constructed from materials brought from the redundant church of All Saints North Peckham. This remarkable feat of dismantling and building carried out by local Biggin Hill people was accomplished through the initiative and vision of the then vicar, The Revd. Vivian Symons. He mobilised the local parishioners to create a truly worthy parish church in place of their ageing corrugated iron building. This fascinating story is recounted in an illustrated colour guide available from the Church.

St. Mark's is a pilgrim church; we do not simply accept the status quo, we are on a spiritual journey as pilgrims of old, actively seeking to draw closer to God and discover His will both in our own lives and the life of our local church and community which we love and serve. We are anxious "not to store up treasures here on earth" but to use all our church resources given by God, in His service and for His glory.

We want to share the good news of God's love in Jesus Christ with all those in our parish and neighbourhood. Hopefully this is portrayed by the way we live our lives, and speak to others.

We respect that we are all children of God, and we want to discover Christ in each other, encouraging personal growth in our individual relationship with each other and with Jesus.

Worship is an integral part of our love for God thanksgiving, and we want our services to reflect dignity and sensitivity as well as joy and.

The people of St. Mark's Church would like you to know that we pray for Biggin Hill regularly.

If you would like us to pray for you, someone you know or for something that concerns you, please let us know and we will be happy to do so. In order to comply with the Data Protection Regulations, please ensure you have the permission of the person to be prayed for.

Please contact the Church office. A message can be left on the answer machine when closed - 01959 577816. If you prefer, you could send your prayer request to St. Mark's Vicarage,

10, Church Road, Biggin Hill, Kent TN16 3LB

Age UK - Bromley & Greenwich	0208 315 1850
Benefit Enquiry Line	0800 88 22 00
Biggin Hill Aperfield W.I.	01959 571360
Biggin Hill Blind Club	01959 572817
Biggin Hill Community Care Association	01959 577400
Biggin Hill Councillors: Melanie Stevens	07900 171266
Sophie Dunbar	07929 365228
Jonathan Andrews (Darwin)	07811 313 559
Biggin Hill Evening W.I.	01959 700973
Biggin Hill Horticultural Society	01959 575799
Biggin Hill Musical Theatre Company	01959 701829
Biggin Hill Residents Association -	07763 215037
Biggin Hill Rangers, Guides, Brownies and Rainbows	01959 575717
Biggin Hill Romanian Group	07802 575417
Biggin Hill Society	01959 572569
Biggin Hill Scout Group	07983 447721
Bromley Council – Office Hours	0208 464 3333
Bromley Council - Emergency out of hours	0300 303 8671
Bromley Social Services - Emergencies only	0203 036 1574
Bromley Assoc. for People with Disabilities (BATH)	0208 663 3345
Childline (confidential helpline for children)	0800 1111 (24 hr)
Citizen's Advice Bureau (Bromley)	0208 315 1940
Community Links, Bromley	0208 315 1900
Crimestoppers	0800 555 111
Dial-a-Ride (For registration and enquiries)	0343 222 7777
Doctor's Surgeries –	
Stock Hill Surgery	01959 580011
Norheads Lane Surgery	01959 574488
Domestic Violence - 24hr Helpline	0808 2000 247
Electrical power cut - to be connected to the local network operator	105
FOAL Farm (Friends of Animals League)	01959 572386
GAS Emergency 24 hr freephone	0800 111 999
National Childbirth Trust (Biggin Hill)	01959 701765
New Life Church	01959 571667
NHS help line when you need medical advice	111
Police: Non Emergency Reporting	101
Local Safer Neighbourhood Team:	
Princess Royal University Hospital	020 8721 2820
St. Mark's Parish Office	01689 863000
St. George's Memorial Chapel	01959 577816
Schools - Biggin Hill Primary	01959 570353
Charles Darwin Secondary	01959 575846
Cudham Primary	01959 574043
Oaklands Primary	01959 572673
Tatsfield Primary	01959 573963
Samaritans (Local branch) - 01689 833 000	01959 577356
Textphone for hard of hearing	24 hr - 08457 90 90 90
Spitfire Youth Centre	08457 90 91 92
St. John Ambulance	01959 574835
Thames Water	01959 701281
Trading Standards Rogue Traders Rapid Response	0845 920 0800
Valley Hall Community Association	07903 852 090
Victim Support Scheme	01959 573917/570020
Westerham Hill Baptist Church	0208 776 7071
	01732 867516



The Next Moving Church News

Edition	Deadline	Distributed from
April - May	10 th March	26 th March
June - July	12 th May	28 th May
August - September	14 th July	30 th July
October - November	15 th September	1 st October

The Moving Church News is published every two months. For more information or for advertisement enquiries please contact Neil Walker - neil.walkerz@gmail.com - 01959 700815 or through the Parish Office

Contributions are welcome especially from local community groups or schools. Please contact Neil as above.

Parish office: 01959 577816

Email: admin@movingchurch.org

St Mark's website: www.movingchurch.org



st mark's biggin hill - 'the moving church'

Keeping up with everything at St. Mark's.
If you want to receive a regular email giving all of the details of events and services at St. Mark's please send your details to Chris Walker. Her email is chrissy.walkerz@gmail.com. Your email address will not be passed on to anyone else.

ADVERTISE HERE!
An ad in full colour costs from just £60 per year.

2800 copies of the Moving Church News are distributed in Biggin Hill every 2 months

Provide your own material or we will design an ad. for you

Contact Neil for more details
01959 700815
neil.walkerz@gmail.com

W. UDEN & SONS LTD

INDEPENDENT FAMILY OWNED FUNERAL DIRECTORS

MONUMENTAL MASONS

Est. 1881

186 Main Road, Biggin Hill

Tel: 01959 573130

(24hr answer service)

OFFERING A FULL SERVICE

PREPAID FUNERALS AVAILABLE

**PRIVATE CHAPEL OF REST
on the premises**



Continuing to build on the family traditions of personal and caring service for over 100 years in the area

We are always available to visit you personally to make any necessary arrangements in the privacy of your own home.

**Branches at Petts Wood, Sidcup, Eltham,
Dulwich, Bexleyheath & Camberwell**