

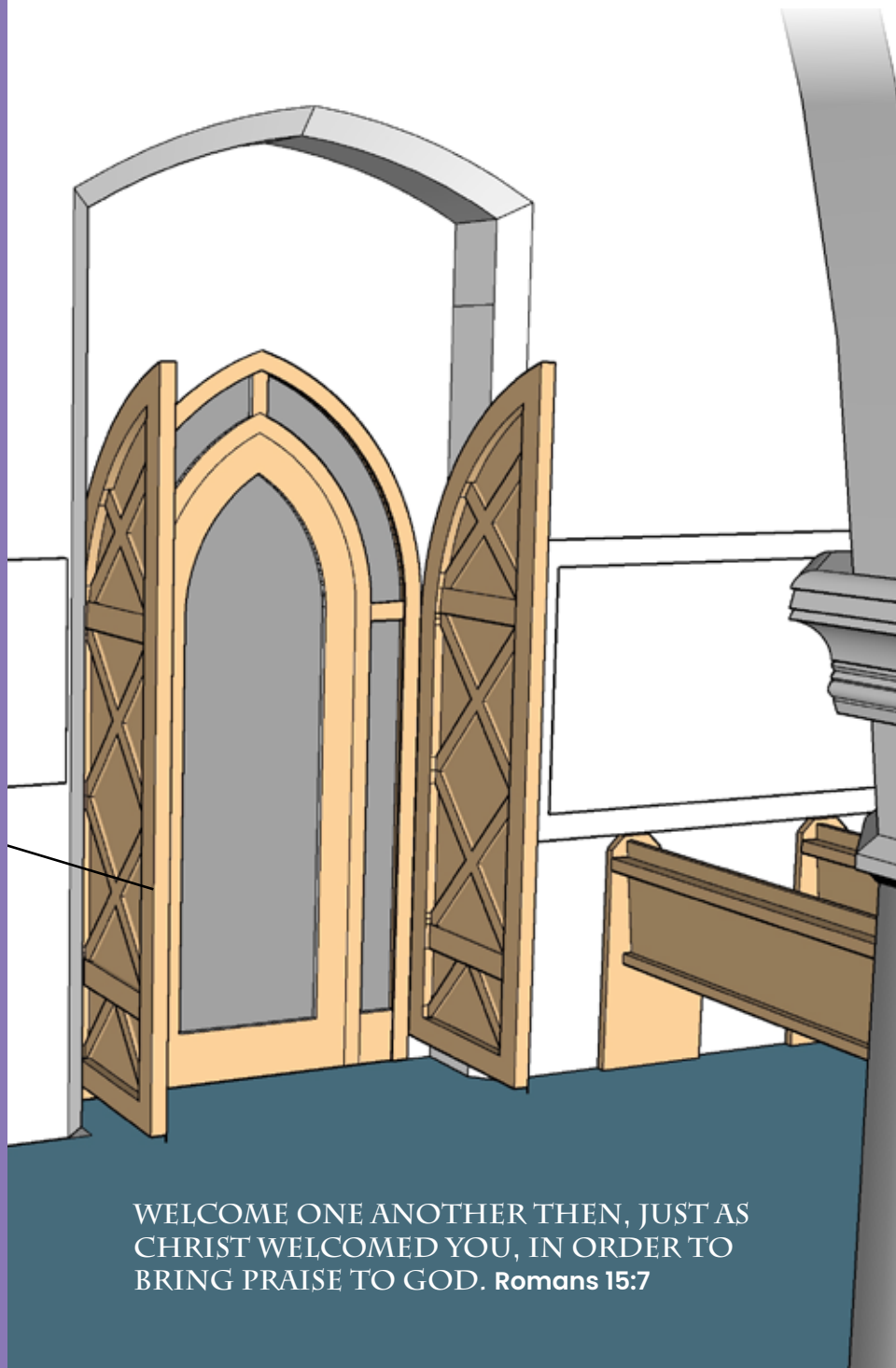

⊕
ROTHLEY
PARISH CHURCH
ST MARY & ST JOHN

OUR VISION IS
TO TRANSFORM
ROTHLEY PARISH
CHURCH FOR THE
BENEFIT OF ALL

OUR MISSION IS
TO MAKE OUR
BUILDING FIT
FOR PURPOSE
NOW AND FOR
THE FUTURE,
FOR CHRISTIAN
WORSHIP, AS
A PLACE OF
HERITAGE AND
TO WELCOME
THE WHOLE
COMMUNITY



WELCOME ONE ANOTHER THEN, JUST AS
CHRIST WELCOMED YOU, IN ORDER TO
BRING PRAISE TO GOD. **Romans 15:7**

The Rothley Parish Church building is one of the village's chief assets, not just for the church congregation, but also for the wider community. This brochure outlines the next stage in achieving our transforming vision and how you can contribute to making the building a welcoming and community focussed space for all ages and abilities.

Our community has grown considerably in the last 10 years with more than 600 houses having already been added. We have found the current community facilities are being used at close to full capacity. Also we are aware of the likely increase in demand with the new development which is occurring within a mile of the village of more than 1800 new homes. Therefore additional facilities and space will be required.

WHY ARE THESE IMPROVEMENTS NEEDED TO TRANSFORM THE BUILDING?

In 2015 the Parochial Church Council (PCC) agreed that, to achieve the vision, there is a need to improve facilities in the church building. The first stage, enhancements to the church audio-visual system and church lighting, has been completed.

The consultation process with our Architect, the Diocese and others for the proposed re-ordering started in 2016 but was interrupted by COVID. Our Building Improvement Group re-started it 2 years ago and we now have the detailed proposals which are set out in the following pages.

THE MAIN DOOR: IMPROVED ACCESS AND VISIBILITY

WHAT IS NEEDED

- The current door is not welcoming and those arriving cannot see what is happening inside.
- An accessibility survey in 2016 found that the entrance ramp and oak doors (unless both are opened fully) do not meet accessibility standards on several counts.
- There is often congestion at the door.
- The solid wooden doors do not convey to newcomers the right first impression of us as an open, forward-looking church community.

WHAT IS PROPOSED

- A glazed door, wider than the single inner door normally used, to replace the inner wooden doors to the northern (main) entrance to the church. This will allow people arriving to see what is happening in the church. It will also give easier access to and egress from the church (thereby avoiding some of the congestion which currently occurs).
- The floor levels (to the external path, within the porch and the currently ramped area immediately inside the church entrance) to be realigned to address level changes and facilitate wheelchair access.
- The current inner wooden doors to be retained and secured in the open position.

[View the Architect plans](#)

or scan the QR provided here

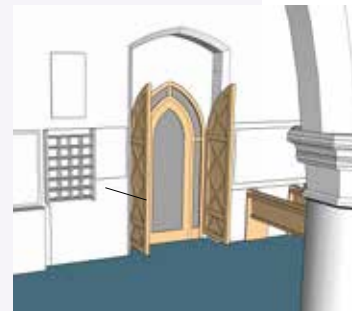

A SERVERY: IMPROVED FACILITIES

WHAT IS NEEDED

- The current circulation area at the back of church, where drinks are dispensed, along with occasional food, does not currently have a mains water supply for hand washing, wash up facilities and the necessary drainage for these functions.. This is not in keeping with current environmental health standards.

WHAT IS PROPOSED

- Improve provision at the back of church to cater for serving food and drink. This will include a serving counter, sinks and running hot water and additional storage facilities.

[View the Architect plans](#)

or scan the QR provided here

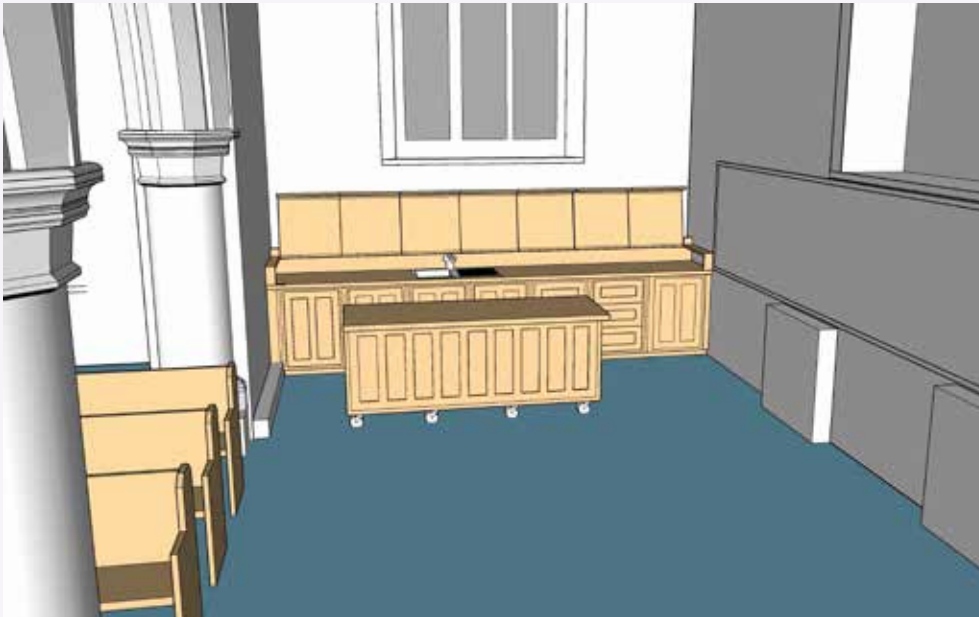

TOILETS: NEW IN THE CHURCH

WHAT IS NEEDED

- There are many groups that use the church. Currently the only toilet provision is in our church hall, approximately 100 metres from the church building, requiring a journey on foot, possibly in inclement weather, and therefore not a desirable situation for anyone.
- The building is frequently used by the school, who have pointed out that the remoteness of the existing toilet facilities causes them significant practical problems in managing large numbers of children. Similarly, for community events and visitors there is now an expectation that facilities will be more easily accessible. Added to this, there can be an inadequacy when there is simultaneously a group using our church hall as well as the main church building.
- A building equipped in this way will provide options for developing other uses where we welcome and reach out to the local community, eg meetings, concerts etc.
- The five yearly architect's inspection in 2015 required by the Diocese recommended a minimum of one accessible toilet.

WHAT IS PROPOSED

- Two toilets, including handwashing and drying provision – one unisex and the second adapted for people with disabilities and also equipped with baby changing facilities.
- This area to be constructed with appropriate sound proofing.

[View the Architect plans](#)

or scan the QR provided here



ADDITIONAL AND IMPROVED MEETING SPACES

WHAT IS NEEDED

- The current crèche area is in the cold and draughty tower which hinders the tower door functioning as a fire exit.
- Currently we have insufficient meeting spaces in the Old School Rooms for all Sunday School classes and no enclosed space for smaller general church meetings, eg prayer meetings, and young people's groups.

WHAT IS PROPOSED

- A ground floor Choir Robing Room which will provide a far more appropriate space for the creche as well.
- A new upper meeting room to provide an additional room for the Sunday School.
- This upper meeting room / storage space will be accessible by both stairs and a stair platform lift, thereby providing access for all.



[View the Architect plans](#)

or scan the QR provided here

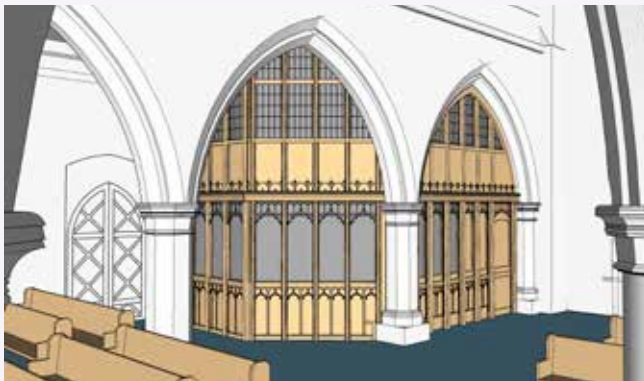

INCREASED STORAGE

WHAT IS NEEDED

- There is a lack of storage space in the church.
- Current storage on the top of high cupboards is unsightly and unsafe.
- Proper storage space is required for the choir music.

WHAT IS PROPOSED

- The storage provision in both the upper room and other spaces will give safe and appropriate storage space in the church.
- The choir music will have appropriate storage provision.

[View the Architect plans](#)



or scan the QR provided here

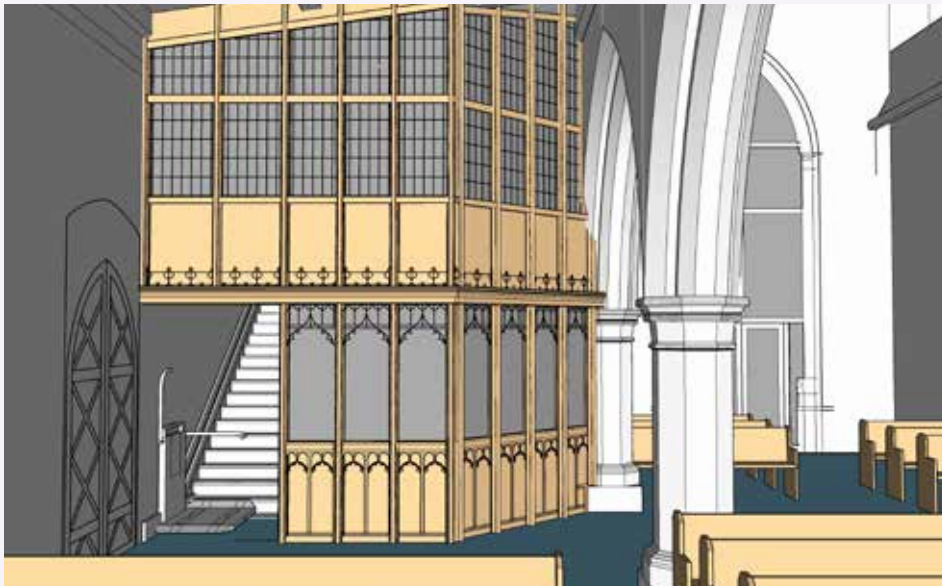

WHEN WILL THE CHANGES HAPPEN?

- An approval Faculty will be required before any works can be started. This will hopefully be granted by spring 2024. The work will be started as soon as possible after this and, hopefully, substantially complete by Christmas 2024.
- To enable the works, once commenced, to carry on until completion, a financial plan will be needed showing, for the complete project, the total estimated cost, the amount of money already gifted or promised, that obtained from charitable or other Trust Funds and that loaned to the church (to be repaid).
- Due to increasing costs, an immediate start will be made once the necessary permissions have been granted to enable the earliest possible completion: a duration of a little over a year is anticipated for the works.

HOW MUCH WILL THE SCHEME COST?

- The Architect is currently preparing detailed costings. The overall figure is estimated at £320,000 plus VAT, however most (if not all) of this should be recoverable, thus we need to raise £195,000 in addition to that already pledged by our PCC from funds available..

WHERE IS THE MONEY COMING FROM?

The Parochial Church Council has already allocated £125,000 from legacies. Other sources are:

- £255,000 from donations (including associated Gift Aid), fundraising and grants from trusts and charities.
- Interest-free loans to 'bridge the funding gap' to enable the works, once started, to be completed without interruption.



HOW CAN WE CONTRIBUTE?

- Additional giving specific to this project by church family members (including Gift Aid where appropriate) by way of one-off gift/s or Standing Orders (monthly / quarterly / annually).
- Considering whether you are able to make an interest-free loan to the church (to help bridge any funding gap) to be repaid as funding income permits.
- Participating in any fundraising activities.
- Filling in and returning the Pledge of Support form attached to this leaflet and actioning those commitments made as appropriate.



WHAT HAPPENS TO MY GIFTS IF THE PROJECT IS OVER OR UNDER FUNDED OR DOES NOT GO AHEAD?

If the project does not proceed, everyone who is known to have given money would be asked individually if they wanted to:

- Have their gift/s returned to them;
- Allow the funds to be kept in the restricted Church Building Improvements Fund for future building developments; or
- Allow their gifts to be transferred to other non-specific uses within the church.

If the funds raised are insufficient to enable all the improvements to be completed, the PCC will consider whether to adopt a phased approach.

If the monies received exceed the sum required to complete the project, any funds remaining will be kept in the restricted Church Building Improvements Fund for future specific church building / fabric projects.

THANK YOU

Many thanks for reading this leaflet and giving the contents your prayerful consideration. We hope that this leaflet explains the need for these improvements and what is proposed. The PCC are both leading and fully committed to these improvements. That said, these improvements are intended for the benefit of the whole church family – both present and future – and also for the wider community, and to be owned in every aspect from start to finish by all.

With thanks to
Andrew Weightman
for drone photograph



Rothley Parish Church
3 School Street
Rothley LE7 7RA
0116 2302626
(24hr answerphone)
welcome@rothleychurch.org.uk
www.rothleychurch.org.uk
Registered Charity No. 1133832

