



1. Print the template on card stock.
2. Colour both faces.
3. Cut out both faces.
4. Cut out the blank eyes of the cross face
5. Measure a piece of greaseproof paper across the blank eyes
6. Glue this behind the eyes
7. Glue or tape a large lolly stick or straw to the back of one of the faces.
8. Glue the second head to the other side of the first one, the lolly stick will be between both faces.



Have a think about Saul (Paul) in the first face he is unhappy and his eyes are blind. What happened in or story to make this happen.

In the second face he is happy and can see, what changed.

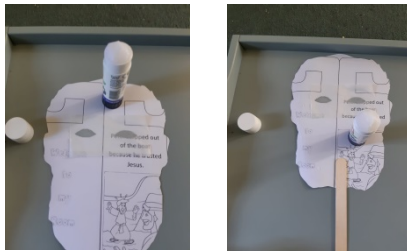

Sometimes we can see the things around us, but we don't see what God is showing us because we're not listening to Him and staying close to Him. How can we get closer to God?

