

The Parish of Newport Pagnell



St Peter & St Paul, High Street, Newport Pagnell, MK16 8AR
St Luke, Wolverton Road, Newport Pagnell, MK16 8JQ

ANNUAL REPORTS

for presentation to the

Annual Parochial Church Meeting

on Wednesday 21st October 2020



Contents

	<u>Page</u>
Rector's Report	3
Churchwarden Report	4
Churchwarden Report	5
Parochial Church Council	
- Secretary's Report	
- PCC membership and PCC Sub-Committees	5
Statistics	7
Safeguarding	7
Mothers' Union	7
Sunday Club	9
Fabric Committee	11
Re-ordering Committee	11
Bellringers	13
Stewardship	14
Communications & Publicity report	14
Events Committee	15
Home Communion	16
Parish Visiting	16
Parish and St Luke's Church Choir	16
Memory Club	17
Treasurers Report	17
Appendix 1	Accounts

Signed on behalf PCC:-

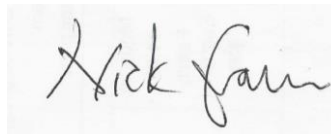

The year was full of events and special services which were all designed to promote the Gospel and draw others into the orbit of church life. These are too many to mention here but are listed in the new parish services and events planner which is freely available to all. There are many people to thank for their co-operation and input into these initiatives. My overview here is to try to assess the spiritual pulse of the benefice so that we can encourage each other and continue to step forward in the right direction.

This sense of a shared ministry is yielding a great spiritual harvest – and this is especially since increasing numbers of the congregation are sharing more about their faith with each other and the community.

More worshippers are talking to each other about prayer and what God has done, and is doing, in their lives and has been a great source of inspiration.

Our sharing of public services and events with the other denominations in the town continues during Easter, Christmas, the Songs of Praise and during Christian Aid week.

Kimonie Nicholls was selected to train for ordained local ministry and began preaching and ministering in the parish as part of her training. Along with Jenny Frost, her work as a warden has been much appreciated by all. The wardens have worked tirelessly at achieving our aim of greater care of the congregation and outreach to the community. This mission strategy is ably assisted by the LLMs, parish administrator and many others who volunteer their time and energy for the Kingdom.

In October Bishop Alan visited us to confirm 10 adults and 2 children from this benefice at an upbeat and well attended confirmation service.

Wednesday morning communion attendance has grown along with the fellowship that this provides. This time has also continued to be used to respond to healing requests from both churchgoers and others from the community.

Discussions and progress have also been made regarding the reordering of the church in the future. This resulted in positive and fruitful visits by representatives of the diocese and an experienced architect.

The tail end of the year has been an unusual one due to the C19 national pandemic which has presented all sorts of new communication and pastoral challenges. Consequently, we have set up a parish Facebook page, WhatsApp facility and parish zoom meetings so that we could keep in touch with as many people as possible during the time that the church was closed. Telephone ministry has increased for those who have no computer access.

A Sunday service was recorded each week from the Rectory and put onto the FB page and the parish website. 1000 to 2000 people viewed our weekly on-line services, and many new people continue to regularly tune in to the Sunday service. The Wednesday morning on-line service also attracts over four times those who attended when services were in church.

We have all had to learn a lot about electronic methods of communication in a short period of time so that we can maintain and evolve new patterns of ministry due to the pandemic restrictions.

Thank you to everyone who has worked hard to keep the church going during these difficult and changing times.

Spiritually, people have been in good heart and have co-operated well to build up the church. The thirst for learning more about the Gospel is a pleasure to see and we also continue to reach out to the community.

I am also grateful to all those who have helped me personally through active support and prayer during the last year. We are evolving into a more loving church and this will help us to face the challenges which all churches across the nation are facing in the future.

Churchwarden Report - St Luke's

Jenny Frost

Well it's been an interesting year.

When I eventually said yes to being warden, I was under no illusion as to my predecessor and his abilities. How on earth could I step into those sandals? Well I couldn't and to be honest, I haven't tried!

I have listened and I hope, learned from Bill.

He and Chris have been my teachers and my friends, and I thank them, and all those, who along with them, have supported me on this journey.

As far as SL goes, the congregation has maintained itself at around 30.

We have enjoyed joint Services throughout the last year, as well as the monthly Evensong at SL.

Our Patronal Festival Bring and share lunch is always a success, and our Easter Flower Cross is a visible testimony to all who walk or drive past on Easter Sunday.

The Irish Dancers moved out late last year, as Claire was given the chance of a studio for their sole use.

Northern Pastures Preschool continue to use the Church as their base Mon - Friday term time and had a very successful Christmas Fayre in December. They have had some staff changes and are hoping to increase the number of children with an open day in March.

The Guiding units which use the Church in the evening maintain a steady contingent. The new fence was erected during the Summer holidays and is a great improvement. The gardener continues to maintain a very high standard in the gardens. However, the recent storms brought down the tree which had been heavy with ivy. This has caused a gap between the existing trellis fence and the wall. This will be plugged as soon as the weather is agreeable. The gardener and her husband will carry out the work as part of their existing contract.

The AV system, which was paid for from out of a generous legacy to the Parish, was installed during the Summer and will see more use as we get used to it.

As my fellow warden, Kimonie, is stepping down as she starts her training for ordination, I'd like to take this opportunity to thank her for all her support, and hard work, over this past year and wish her success in her future role in the Parish.

I look forward to working with the next Churchwarden, should I be re-elected.

This time last year we enjoyed our first Fish and Chip Supper which preceded the annual meeting. Realising that it was possible to have more than the weekly shared Eucharistic Feast in St. Peter and St. Paul, we went on to celebrate the patronal festival in June with a Bring and Share Lunch which was an excellent opportunity for us to come together as a parish for fellowship.

It is always good to use the church for the benefit of the wider community so that they can appreciate their parish church. Over the last twelve months we have had the church open one Sunday afternoon a month for visitors to receive a warm welcome with a friendly face and an opportunity to enjoy a chat over a hot drink and cake. Two such afternoons which were especially popular, bringing others into the church, were the roof tours last summer and the sing along on a cold January afternoon earlier this year.

During the last year St. Peter and St. Paul has opened its doors for 'Pause For Thought' twice. Last May the church was open for quiet prayer and reflection on the theme of the weekly intercessions. This year it was decided to host a 'Pause for Thought' for Lent: over the first weekend of Lent the church was open for people to reflect quietly on their own spiritual journeys and on the environment, including their stewardship of God's Creation.

With four regular services held in St Peter and St Paul most weeks, alongside many other events advertised in the Benefice Planner, much help is needed. My thanks go out to every individual who helps in some way, no matter how small. I am grateful for all your help and support which enables the smooth running of services and the church 365 days a year (366 days this year!); there is no doubt that it has made my job as warden far easier and I know that you will give my successor the same support.

I have enjoyed the privilege of serving you as one of the two wardens in this parish over the last two years. As I step down, I pray that with the Lord's help and guidance, I will continue to serve you as an ordinand within this benefice.

PCC Report

The Parochial Church Council is a corporate body established by the Church of England. The PCC operates under the Parochial Church Council Powers Measure. The PCC is a registered charity. Registered No: 1153668

The PCC met 9 times and the Standing Committee 7 times in 2019-20.

PCC membership

The appointment of PCC members is governed by and set out in the Church Representation Rules.

During the year, the following have served as members of the Parochial Church Council:

Incumbent: Rev Nick Evans, Rector

Licensed Lay Ministers: Mervyn Evans and Karen Goff.

Churchwardens: Kimonie Nicholls and Jenny Frost

PCC Secretary: Olwen Smith

Deanery Synod representatives: Kimonie Nicholls, Dick Smith (Treasurer), John Fowler and Beth Mackay

Elected & co-opted members: Julie Eldridge (until September 2019), Lynda Evans, Doug Hird, Pat Hudson, Brian Hunt, Linda Macdonald (co/opted October 2019), Beth Mackay, Jennifer Mazzone, Ralph Mazzone, Nick Read, Olwen Smith, Ann Townsend, Bill Watson.

PCC Sub-Committees

The Parochial Church Council operates through a number of sub-committees which meet between full meetings of the PCC. They are:

Standing Committee: This committee comprises the Rector, Churchwardens, PCC Secretary and Treasurer. It has delegated powers to transact some of the business of the PCC between its meetings and deals mainly with housekeeping matters.

Fabric Committee: This committee attends to the maintenance of the Parish Church, St Luke's Church and 3 Castle Meadow Close, and considers future projects.

Events Committee: Established in October 2018 as an overarching committee to support organisers of events, providing support, advice and identifying possible helpers. Also, will identify new events and provide advanced planning.

Re-order Steering group: This group was established in January 2019 and will oversee and guide the re-ordering project.

Parish Visiting team: Established January 2020 to oversee and provide for the needs of those who request visits.

Statistics

	Baptisms	Thanksgiving	Weddings	Blessings	Church Funerals	Crem Funerals
--	----------	--------------	----------	-----------	-----------------	---------------

2014	28	4	23	0	14	21
2015	35	2	19	1	20	12
2016	34	0	14	1	25	5
2017	25	0	16	0	26	6
2018	13	0	12	1	24	5
2019	15	0	7	0	21	6

Safeguarding

Julie Eldridge

In the last year the Church of England House of Bishops and the Oxford Diocese have further updated their guidance on Safeguarding, including a revision of training. As a Parish, we have our own Safeguarding Policy which is reviewed annually, and it continues to be in line with the requirements of both bodies. As a Church we follow accepted standards of due diligence with regard to DBS checking all those who work with children and vulnerable adults for the Parish and will continue to update these checks in line with guidance.

We have recently reviewed the training requirements for our volunteers, officials and ministry team and arrangements are in place to facilitate any required updates.

In the past twelve months we have had no safeguarding concerns raised.

Mothers' Union

Jennifer Mazzone

Our branch in Newport Pagnell continues to do well (we now have 52 members) when other branches are decreasing in number or closing down. We have such good support from our members for which I am grateful.

During the year I have enrolled four new members:

Sylvia Puddephat, Pam Grace, Barbara Heaton and Cherie Read. These are always pleasurable occasions.

We had several occasions to celebrate during the year. Brenda Jenner has been a member of the Mothers' Union for 50 years; Pat and Dick Parker celebrated their Golden Wedding Anniversary and Pam Grace and Joan Clutton reached 90 years of age.

Our programme last year was varied and interesting. Rev. Canon Glyn Evans, the Rural Adviser for the Diocese, was an excellent speaker.

Two of our members spoke on visits they had made. Sophie Cull had visited the Hand in Hand project in Ethiopia which was so interesting and Margaret St. George had visited Anlung Pi School in Cambodia.

Katie drew discussed the work of the Mothers' Union in Melanesia and the Melanesian project which our church has supported.

Gloria Richards made a welcome return visit to our branch and spoke of the many moves she and her late husband, John, had made as part of their work together.

Mervyn Evans kindly stepped in at our November meeting and gave us an insight into Christianity and the Military.

Rachel Buckley led a Bible study for Advent.

The Branch Festival, was well attended when the speaker was Pam Fielding from Sherington. The URC ladies were invited once again. The service was based on the theme for 2019. Listen, Observe, Act – In Step with God.

Nick led the annual Quiet Afternoon which was well attended despite it being a busy Sunday with the Confirmation taking place in the evening. I would like to thank Nick for his support of the Mothers' Union and our branch in particular. Many branches do not have this support from their Incumbent which can have a detrimental effect.

It is good for members to meet socially. The Coffee and Chat at the home of Linda and Alex was an enjoyable occasion as were the Cream Teas in our garden. We were blessed with good weather and it was very well attended. The proceeds were divided between the Relief Fund and AFIA.

Our annual lunch at The Red House was, once again, very enjoyable.

In March, several members travelled to Abingdon for the Lady Day service and the commissioning of the Diocesan president and the Trustees. We treated ourselves to a pub lunch prior to the service!

In October we went to Akeley where we had a delicious soup lunch followed by a speaker from Mary Sumner House who was very interesting and she was also interested in our local projects.

The Comfort Book took a long while to collate and publish but finally copies were delivered to all the churches in the town, the Care Homes, the chapels in Christ the Cornerstone and the hospital, Nick and individuals who wanted their own copy. The book was well received and really appreciated so it was well worth the effort.

With invaluable help from Moira, we once again co-ordinated the donation of Christmas cards to every prisoner in Woodhill. The prison provided stamps so each prisoner could send a card to a loved one. We hope this will be an annual event.

Other projects undertaken:

- Providing daffodils for Mothering Sunday

- Assisting in Baptism Preparation
- Assisting with Marriage Preparation
- Supporting Baby Basics
- Sending cards to couples who are to be married
- Sending cards to those in our church community who are experiencing illness, bereavement or to those who are celebrating special birthdays or anniversaries

Thank you to Pauline Middleton for sending these cards which I know are really appreciated.

We ran the raffle at the bazaar which always raises a substantial amount of money. Thank you to June Weston for organising this and to Jill Mapley for obtaining prizes from businesses around the town.

Our branch provided a tree at the Christmas Tree Festival once again.

I would like to thank my committee who work so hard to support me all the way along. It helps to run the branch smoothly.

We must continue to spread the word about the Mothers' Union and our work both locally and nationally. We are always looking for new members, men, women, married or single. Attendance at meetings, although enjoyable, is not compulsory to becoming a member. We belong to a worldwide Christian organisation supporting marriage and family life.

May we look forward to another fulfilling year in 2020.

If you are interested in finding out more about the Mothers' Union and the invaluable work it does please contact Jennifer Mazzone (Branch Leader) on 01908613088 or jennifermazzone@hotmail.com

Sunday Club

Glenda Winfield

This report reflects the Sunday Club activities for 2019.

Our relocation from Brooklands to the Church Vestry, where we have our own child-sized table and chairs, has worked very well. A group of usually 6 children meet on the second and fourth Sundays of the month. We are extremely fortunate to have dedicated Sunday Club Leaders, working on a rota; they are generous with their time and talents. A group of Leaders attended the Parish Safeguarding Training morning, delivered on behalf of the Diocese of Oxford Safeguarding Team.

Through Lent to Easter we used Sam McBratney's story Guess How Much I love You as the theme for the children's sessions and this was also included as part of the Mothering Sunday Service. There was an Easter crafts session on Easter Day and the children enjoyed the traditional Easter Egg Hunt after the service. After Easter, the

children heard about Jesus after the resurrection and, following Pentecost, their sessions were based on the new testament lectionary until the summer holidays. A group of children and their parents met up for a very enjoyable end of term ten pin bowling session in July. In September we began a project on Joseph and his Coat of Many Colours. There followed an opportunity for the children and the wider congregation to spend an afternoon watching the DVD Joseph and His Amazing Technicolour Dreamcoat at St Luke's. The Joseph theme was continued through to the Christmas Tree Festival when the Sunday Club's contribution was a wonderful "technicolour" Christmas tree, constructed using lots of different coloured plastic fruit juice bottles.

A tabletop games afternoon at St Luke's on a cold November afternoon was enjoyed by the children, parents, leaders, and some members of wider congregation. Tea, coffee, and cakes were also on offer.

There were some memorable activities during Advent and Christmas. The Christmas Crafts Stall at the Christmas Lights Bazaar, the journey of the Travelling Crib around the parish during Advent and the Christingle Service. The Gift Service saw generous donations of Christmas gifts for distribution by the Daisychain Children's Centre in Bletchley. The Crib Service was amazing, using the theme of Symbols of Christmas. A great deal of time and effort went into putting this service together and creating the splendid costumes. There were also some very good sports who donned the costumes and walked up the aisle in them. A large group of Sunday Club children, leaders, their families and friends had a wonderful time at the MKAOS Pantomime Sleeping Beauty at The Venue, Walton High School.

Sunday Club weekly offertory has continued to support Hand in Hand in Ethiopia, a small children's charity working in Addis Ababa providing education and promoting good health. A member of our congregation, Sophie Cull, very kindly came along to Sunday Club to tell the children about, and show pictures of, her and her daughter Flo's trip to Ethiopia to visit to the charity. We took some photographs and drew pictures in Sunday Club, for Yonathan Darge, whom Sunday Club sponsor, which were to be taken out by the organisers on their next visit.

From January through to the unfortunate restrictions caused by the Coronavirus Pandemic and subsequent lockdown, our usual activities for Palm Sunday and Easter were curtailed. We sourced online Sunday Packs for the children, Together at Home, which are being distributed to the children each week, giving them the opportunity of an Old or New Testament lesson, lectionary or non-lectionary. The children sometimes send their drawings and colourings to be included in Pews News.

Fabric Committee

Doug Hird

The purpose of the fabric committee is to do actual work rather than have meetings. It focuses on the day-to-day needs of the church structure, keeping the building in a

fit state for the congregation. The group keeps an eye on the larger projects, such as the re-ordering project and the organ, to help out when needed and to make sure everyone works together. The quarterly meetings that the committee holds spend most of their time on a medium term list and plan, prompted mainly by the last quinquennial inspection. All of these items are either completed, in hand or planned.

I have to thank the members of the committee who have contributed their time and abilities over the years and give particular thanks to Ralph Mazzone who is stepping down after many years of service. Of course, you don't need to be part of the committee to contribute. Anyone can help out, especially if they see a need they can fill.

If you would like to get involved then let us know.

Re-ordering Committee

Mervyn Evans

"A building that celebrates the past, lives in the present and embraces the future."



Progress During the Year

Steady progress is being made in our attempt to improve the layout and flexibility of the interior of the Parish Church. During the past year the architect, Jeremy Bell, has presented the results of the completed Feasibility Study to the congregation and members of the local community. Input has been received from some of the local users and the Diocesan Advisory Committee Secretary, Liz Kitch, has been helpful in guiding the process.

In October members of several heritage bodies visited the church and were briefed on the project. The feedback from that visit has been received and was discussed at a meeting with the architect and the DAC Secretary last month. In addition, a "Statement of Significance" has been professionally prepared listing the historically important aspects of the church building and contents.

Proposals

The proposals for reordering are:

Phase 1

1. Replacement of the existing toilet and servery in the west end with three toilets, one of which will be accessible.
2. Relocation of the servery to a purpose-built enclosure under the west window.
3. Refurbishment of the south porch.

Phase 2

1. Removal of pews and pew platforms. Six pews to be retained and used for social seating in the aisles.
2. Laying new, level, flooring in place of the pew platforms. The tiled area at the west end and the tiled aisles will be retained.
3. Renewing the heating system.
4. Renewing the lighting in the Nave.
5. Redecoration of the Nave.
6. Purchasing new seating.

Phase 3

1. Reconfiguring the sanctuary and providing ramped access to a new dais.

What Comes Next?

The proposals listed above will need to be justified in a "Statement of Need" and the need for any change has to be balanced against the historic importance of the affected areas as listed in the "Statement of Significance". A first draft of the Statement of Need has been prepared and submitted to the DAC.

The heritage bodies had no objection to the proposals listed in Phase 1. The architect has been asked to submit a cost for preparing detailed plans and elevations for the work in Phase 1 which will then be presented to the PCC for approval. Once the plans have been agreed and prepared we will be in a position to apply for a faculty.

The heritage bodies have requested that we research the history of the pews, which we have now done. The pews were built locally by J. M. Mitchell, Carpenters, in their workshop next to the Iron Bridge. The pews were installed in the 1880's replacing the existing boxed pews, though not without some vigorous objections from certain members of the congregation!

The enlargement of the dais in the sanctuary proved contentious. The issue was the covering up of what some thought to be the historically important and attractive ledger stones in the floor between the existing dais and communion rails. We will need to put together a clear requirement for this work and explain how we would intend to use the revised layout.

Finance

The total project cost will be around of £1.1m at present day costs though we will undoubtedly see some inflation in this figure depending on the length of the project. Fundraising for Phase 1 will begin this year and a dedicated fundraising group will

need to be set up. If you would like to help in this vital role, then please speak to Mervyn, Malcolm or Dick Smith.

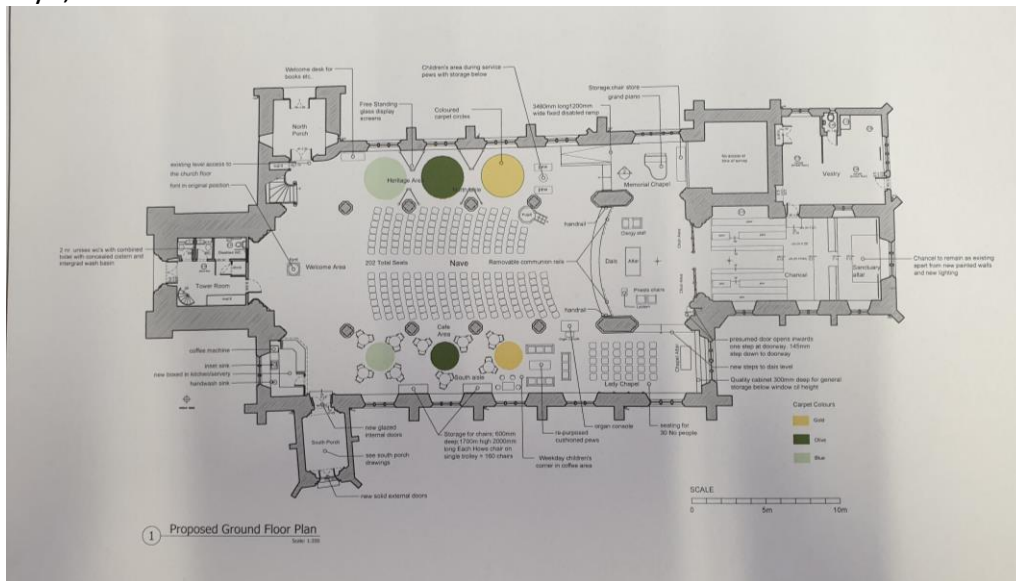

Bellringers

Doug Hird

2019 has been a year of reducing numbers. We now only have three actual Newport ringers who ring on Sundays. We still get regular support from the Sherington band which will keep us above complete collapse for the next few months. Practices are reinforced by ringers from Hanslope but University will take some of these away in the next year. Weddings have been supported by ringers from other towers in the area as well and this will have to be continued into 2020.

So we need to do some recruiting this year. Similar thoughts are being discussed with the Olney ringers and a North Bucks campaign, based on Central Milton Keynes is being planned. In support of the teaching of learners, the Victorian handbells have been restored and missing bells replaced which will make them useful again. The bell sensors for the simulator software have all been upgraded and these are more reliable than the original ones. A more long term asset will be the restoration of Lathbury's bells over the next few years.

Stewardship

Dick Smith

Planned Giving is a vital part of our income, and regular members of the congregation should commit to regular giving throughout the year. During the year Planned Giving has dropped by a further £2,000 below the 2018 figure.

Recovery of Gift Aid from HMRC has therefore also dropped, and therefore our income in 2020 is likely to be £400-500 down on 2019 (we have to claim this in arrears).

We would welcome new members to the Stewardship scheme. We had hoped to hold a Stewardship Campaign and introduce a new method of paying your commitment by Direct Debit as well as the current methods, but other priorities prevent that. We hope to do that during 2020, but if you are regular attendees at any of our services please consider joining the scheme. Contact me for further information (nppc.treasurer@gmail.com or 01908 616508)

Communications & Publicity Report

Moira Evans

The Benefice Planner for 2019 proved useful and was appreciated by the congregation and the less regular church goers so a 2020 version has been produced and the planner is now part of our ongoing communication strategy.

Social Media is still proving to be effective in publicising our events and services to the town and community with some visits directly attributable to Facebook posts. The Town Council website also publishes our events.

We have started to occasionally email our database with details and reminders of special services and events

We have been able to use Google Analytics over the last year to review the use of our own website and this has shown a steady but small number of visitors over the year.

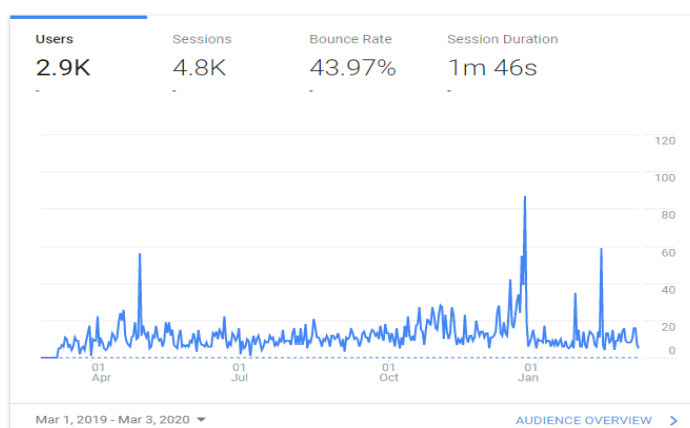

The largest peak being at Christmas time, the other peaks not relating to anything in particular! Going forward we will be able to compare year on year the visitor numbers.

The most visited pages of the website other than the Home page are the news pages, calendar and St Peter & St

Paul.

The Benefice Magazine continues to be produced and continues in its purpose of keeping the congregations informed of past and forthcoming events. In 2020 it is planned that three editions will be produced, Feb, June and Oct.

Events Committee Report

Lynda Evans

It has been a busy year for the parish.

Many volunteers have enthusiastically organised large and small events that were well attended and enjoyed by those who came along.

Trips have been organised to cathedrals and refreshments were served after family services.

The Advent & Christmas period was a particularly busy time with the Christmas Tree Festival and Christmas Fair bringing many visitors into the Parish Church.



**Confirmation Cake
designed & baked by
Bridget Frost**

The committee meets 4 times a year and looks in detail to see how we can help.

We look at questions like the ones below.

- how did the events go that took place in the last 3 months? Could we help improve them for next year?
- who is getting the cakes after a special service?
- who is organising publicity and sign-up sheets for an event?
- who is opening up and closing the venue?
- do we need to move pews? Who is going to move them and when?

During the last year, we purchased a small portable tabletop fridge that we use to store milk for multi day events or when the weather is warm.

One of the things we have noticed in our revue of events is that we use a lot of plastic cutlery. As our aim is to reduce the amount of plastic we use, we decided to buy some stainless-steel cutlery that can be used in both churches for events such as patronal lunches and fish and chip suppers.

The forks will be used all year when we have refreshment tables with cakes.

The committee welcomes feedback on past events and ideas for new ones.

If you would like to help out at events or join the committee for a year or two, please let me know.

Our thanks go to all those who have organised, baked, stewarded, moved pews and made themselves available to 'help out' at events. None of them would happen without you.

We look forward to the coming year and its fresh opportunities for fellowship amongst our congregations and with those who visit our churches.

Committee Members for 2019-2020

Julie Eldridge, Lynda Evans (Chair), Moira Evans, John Fowler, Pat Hudson, Brian Hunt**, Jennifer Mazzone,*

The Mayor joins in with the Human Fruit Machine fun at the Christmas Fair



Beth McKay, Kimonie Nicholls, Dick Smith, Olwen Smith

** stood down November 2019 ** joined June 2019*

Home Communion

Marlene Smith

Communion has continued to be held at Castlemead and Westbury Grange. We also now visit Tickford Abbey on a monthly basis. We regularly visit about 6 individuals in their homes to administer Communion. This can either be on a weekly, fortnightly or monthly basis. I maintain a confidential log of who was visited, by whom and when for safeguarding purposes.

If there is someone you know who you think would like to receive home communion please speak to them, and if they consent to their details being passed on, please contact me so that I can arrange with them for an appropriate person to take them communion.

Parish Visiting

Kimonie Nicholls

In January 2020 the PCC made the decision to set up a parish visiting scheme and appointed me as co-ordinator.

The idea of the scheme is that the parish visitors, who are approved by the PCC, minister the love of Jesus to others, through their words, their actions and their prayers. The scheme, including details on how to request a visit, has been advertised through the parish website, pews news, and church notice boards. During its first month there have been three requests for visits and interest from a member of the congregation to join the initial team of nine. Although in its infancy, the scheme has shown to have a promising start.

Parish and St Luke's Church Choir

No report received

Memory Club

Hazel Reynolds

It has been another successful year for the Memory Club. In February we passed our 5 year anniversary. We increased our hours from one & a half to 2 hours nearly a year ago, primarily to give Carers a two hour break from their caring responsibilities. We still meet on the 2nd & 4th Thursdays each month.

Our membership remains pretty steady, just over 20 on our books but a regular attendance of 14 or 15. However, by the nature of things, there is quite a lot of turnover & I regularly have to ask Malcolm for more name badges - we are constantly aware of just how many possible first names there are! Happily there is less change amongst the volunteers, but inevitably there has been some. We need to update our DBS records as soon as our Safeguarding Officer can advise what is required. More volunteers would be welcome at any time.

Major events in the last year were the Christmas Pantomime at MK theatre - "Aladdin", & a picnic held at Great Linford Manor Park in conjunction with The Parks Trust - all the Memory Clubs combined for that outing; we were fortunate to have a lovely warm & sunny day. Our much advertised Mosaic of Newport Pagnell is now displayed on the wall on the first floor of the Medical Centre.

Based on our success, Milton Keynes now has 4 Memory Clubs, ours plus the new one I was instrumental in setting up in Stony Stratford January 2019 & the two now run on a weekly basis by Age UK MK. They are vitally important as more & more charities cease their club activities presumably due to loss of Council funding, Alzheimer's Society included.

We are grateful to the PCC & the Parish Church for their support & providing our insurance & the all important support on administrative & financial matters.

Treasurer's Report

Dick Smith

Our income in 2019 increased by £37,000 but this was mainly due a legacy of £33,000 received during the year. Planned Giving dropped by £2,000, but general collections improved which has softened the loss. Tax Recovery was on a par with the previous year because we have to claim a year in arrears, but we will see a reduction in 2020 because of the drop in Planned Giving this year. Donations were better, and we received a grant from the Diocese towards our Re-ordering project, Income for the Memory Club was higher due to several unexpected donations, and our Miscellaneous income was boosted by a couple of large sums left in the Nave Safe. Income from Fees (Weddings and Funerals) was down because we had had even fewer weddings this year. However our Events income increased again this year with several additional events as well as the Christmas Fair and Christmas Tree Festival..

Expenditure decreased from the high figure last year (which was due to the work undertaken on 3 Caste Meadow Close). However we spent £21,000 on projects agreed with the family of the legacy (New Chancel lighting at SSPP and an

audio/visual system at St Luke's). We also had to replace a lot of the fencing at St Luke's at a cost of £3,700. CCTV cameras have been installed at SSPP although the cost was covered by a generous donation from a benefactor, and we also spent £5,500 on stonework repairs. Work also commenced on a Re-ordering Project in 2019 spending £16,000 on architect fees and survey costs. This has been covered by money from General Funds which will be replaced once we start fundraising for the work to be undertaken. Other costs were on a par with the previous year.

Fortunately we have seen an improvement with our investments this year seeing an increase of £58K after a drop of £15K in 2018.

During the year we took part in a Diocesan trial of contactless card readers, and as a result we have a permanent machine at SSPP and a hand held unit for use in either church. These are particularly useful at events, special services, weddings and baptisms. We only gained the units in September but we saw a useful income from them and hope to make full use of them during 2020.

Reg Wright has continued to undertake the independent examination of the accounts this year, and I would like to thank him for his work. The PCC approved the accounts at the PCC meeting on 16 March.

I would also like to thank Bill Watson and John Fowler who diligently bank the money collected each week from the various services.

Appendix 1

Accounts