

**NOTES**

Oak screen to be constructed using kiln dried European oak. Osmo oil finish.

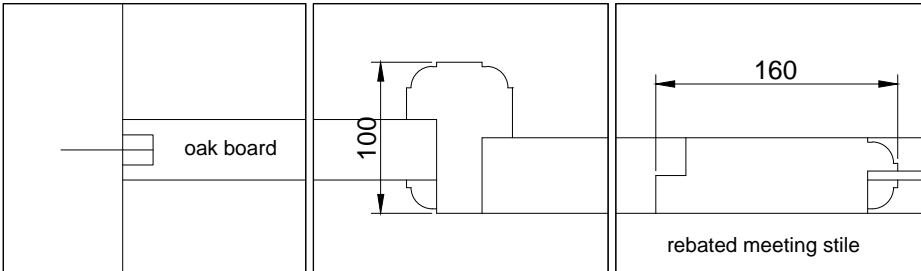
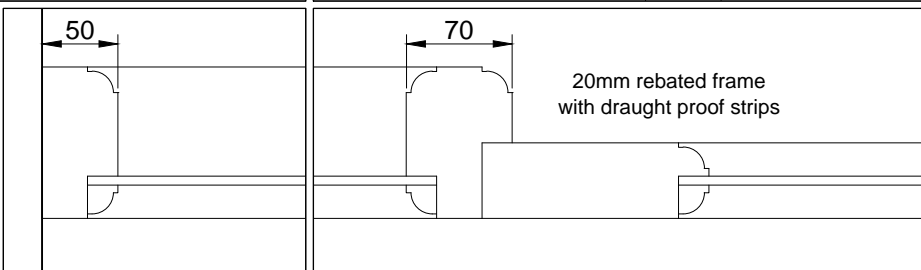
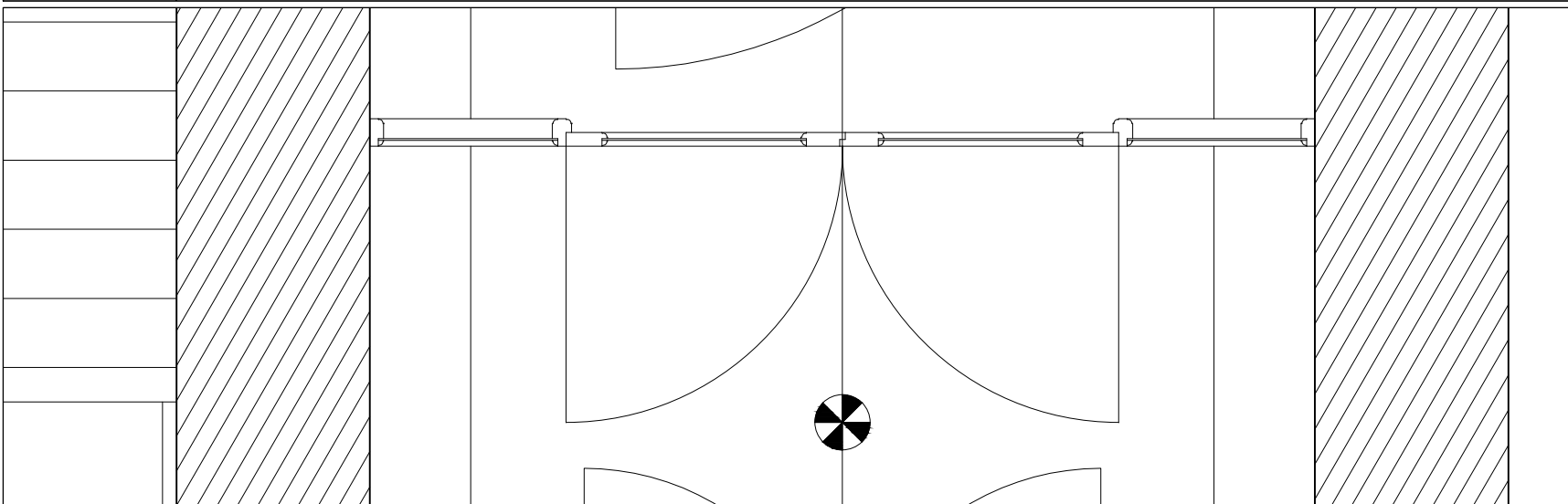

Autocad drawing - from file 135006 Layout 13

Client: St Peter's Heversham PCC

**Paul Grout Associates**  
01539 741199

**ST PETER'S, HEVERSHAM  
ENTRANCE AREA**

**PORCH DOOR SCREEN  
AS PROPOSED**

Scale: 1.25 & 1.5(A3) Drwg: 135/ **13A**